

DESCRIPTION

This series keystone jacks work together with high speed cables, cords and panels to provide performance beyond proposed Category 6A standards, a new feature of this series jack is a universal colored wiring label that eliminates the need for separate codes for T568A/B wiring scheme.

APPLICATION

- Available in Cat6A, T568A/B wiring, meet or exceed TIA/EIA Cat6A requirements
- Housing : high temperature thermoplastic
- Compact jack design, 8 positions and 8 conductors
- Contact : phosphor bronze , phosphor bronze with 15 μ " ,30 μ " or 50 μ " gold plate can be selected
- Accept 23-24 AWG wires
- Easy to be terminated, low attenuation loss and high return loss
- High reliability and superior performance
- Available in different colors

Ningbo Doppler Communication Co., Ltd.

No. 19, 3rd Binhai Road, Hangzhou Bay New Zone, Ningbo City, Zhejiang Province, CHINA.

Ningbo Doppler Communication Co. Ltd. reserves the right to change specifications without prior notice

PRODUCT DIMENSION

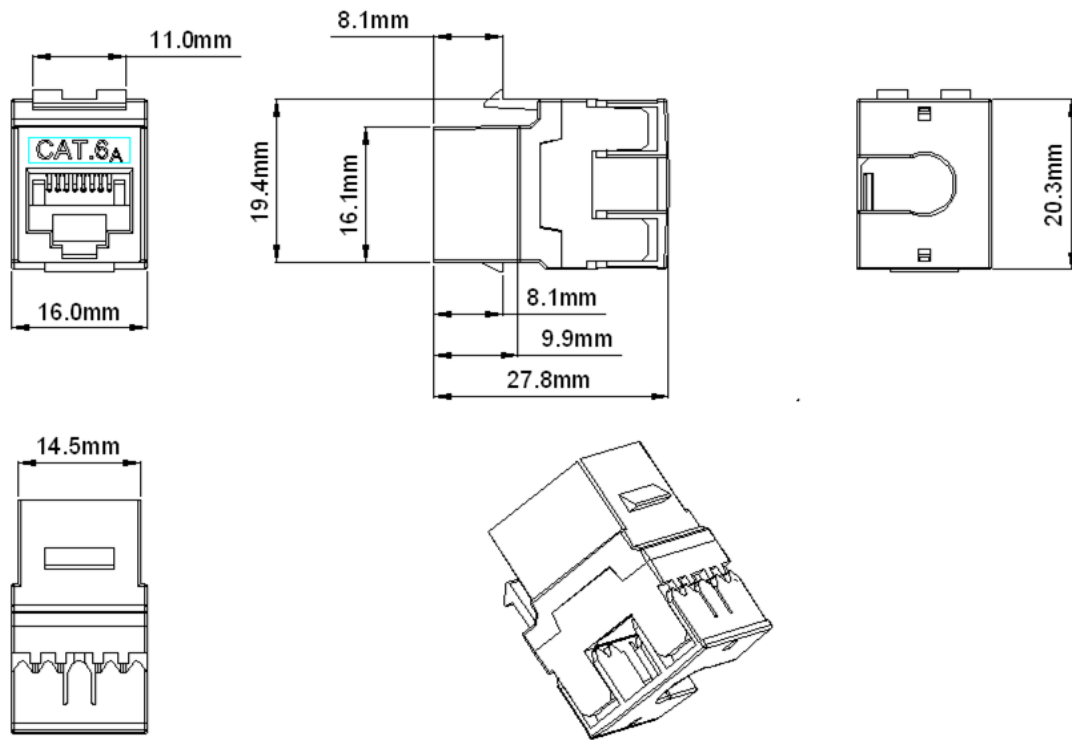

CONSTRUCTION

<i>Description</i>	<i>Parameter</i>
Contact resistance(max)	20mΩ
Insulation resistance(min)	500MΩ
Return loss(dB)	5.2dB

Ningbo Doppler Communication Co., Ltd.

No. 19, 3rd Binhai Road, Hangzhou Bay New Zone, Ningbo City, Zhejiang Province, CHINA.

Ningbo Doppler Communication Co. Ltd. reserves the right to change specifications without prior notice

PERFORMANCE

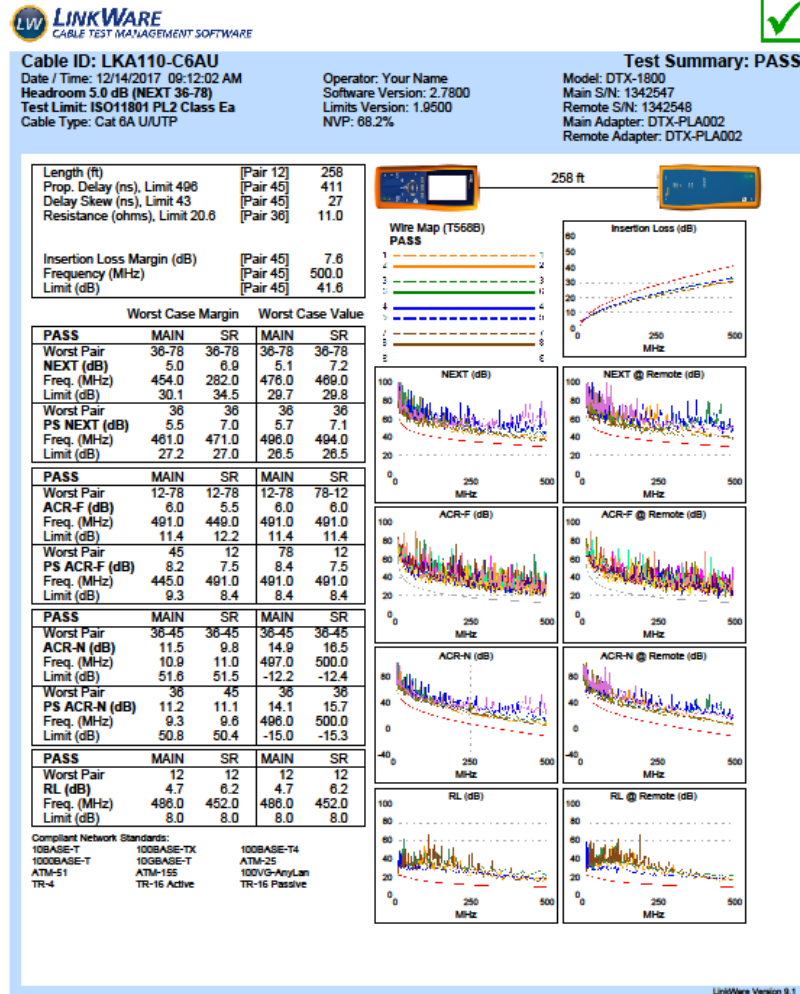

ORDER INFORMATION

Part No.	Description	Color	Inner Box	Carton	Carton measurement (L*W*H)	Weight
LKA110-C6AU	Cat6A unshielded keystone jacks (180 degree)	White	25PCS	250PCS	53cm x 31cm x 23cm	3.80KG

Ningbo Doppler Communication Co., Ltd.

No. 19, 3rd Binhai Road, Hangzhou Bay New Zone, Ningbo City, Zhejiang Province, CHINA.

Ningbo Doppler Communication Co. Ltd. reserves the right to change specifications without prior notice